

£200,000

St. Davids Road, Southsea PO5 1QH

**bernards**  
THE ESTATE AGENTS



## HIGHLIGHTS

- ❖ SPLIT LEVEL APARTMENT
- ❖ TWO BEDROOMS
- ❖ FOUR PIECE BATHROOM
- ❖ OPEN PLAN LAYOUT
- ❖ GREAT SIZE LIVING SPACE
- ❖ OFFERED CHAIN FREE
- ❖ IDEAL FIRST TIME BUY
- ❖ GREAT INVESTMENT
- ❖ COMMUNAL PARKING
- ❖ POPULAR LOCATION

**\*\* SPLIT LEVEL APARTMENT OFFERED  
CHAIN FREE IN POPULAR LOCATION \*\***

We are delighted to offer for sale this exceptional size two bedroom apartment in ever popular St Davids Road. With split level accommodation and offered with no onward chain, this superb opportunity for either a First Time Buyer or Investor is not one to be missed

As you make your way up the stairs to the property, you'll be taken a back by the size of the rooms and hallways. Two double bedrooms of similar size, a great size 4

piece bathroom space and an exceptional; open plan lounge / kitchen / dining area, this really is an apartment offering much more than the average.

The home also has proved to be a superb investment with it being rented out for a period of time, There is a communal parking spaces for the building as well as a really convenient location offering a short walk to the vibrant Albert Road as well as short journeys to the train station, Gunwharf Quays and Southsea seafront.

With no onward chain, we look forward to hearing from you for an internal inspection.

Call today to arrange a viewing  
02392 864 974  
[www.bernardsea.co.uk](http://www.bernardsea.co.uk)





Call today to arrange a viewing  
02392 864 974  
[www.bernardsestates.co.uk](http://www.bernardsestates.co.uk)



# PROPERTY INFORMATION

## ENTRANCE HALL

### BEDROOM 1

12'6" x 9'8" (3.81m x 2.95m)

### BEDROOM 2

12'5" x 9'8" (3.78m x 2.95m)

### BATHROOM

13'1" x 8'7" (3.99m x 2.62m)

### LOUNGE / KITCHEN / DINER

24'3" x 14'1" (7.39m x 4.29m)

### Anti-Money Laundering (AML)

Bernards Estate agents have a legal obligation to complete anti-money laundering checks. The AML check should be completed in branch. Please call the office to book an AML check if you would like to make an offer on this property. Please note the AML check includes taking a copy of the two forms of identification for each purchaser. A proof of address and proof of name document is required. Please note we cannot put forward an offer without the AML check being completed

### Council Tax Band B

Portsmouth City Council: Band B

### Leasehold Information

Management Company : Lease Length : 117 years Ground Rent : £150 Service Charge : £480

Please note that Bernard's Estate Agents have not checked or verified the lease terms or the service charge/ground rent costs. The information provided above has been provided to us from the Seller. Your solicitor will check all of the above during the conveyancing process and you should only rely on information provided by them when making the final decision as to whether to buy any leasehold property.

### Offer Check Procedure -

If you are considering making an offer for this or any other property we are marketing, please make early contact with your local office to enable us to verify your buying position. Our Sellers expect us to report on a Buyer's procedability whenever we submit an offer. Thank you.

### Removal Quotes

As part of our drive to assist clients with all aspects of the moving process, we have sourced a reputable removal company. Please ask a member of our sales team for further details and a quotation.

### Solicitor

Choosing the right conveyancing solicitor is extremely important to ensure that you obtain an effective yet cost-efficient solution. The lure of supposedly cheaper on-line "conveyancing warehouse" style services can be very difficult to ignore but this is a route fraught with problems that we strongly urge you to avoid. A local, established and experienced conveyancer will safeguard your interests and get the job done in a timely manner. Bernards can recommend several local firms of solicitors who have the necessary local knowledge and will provide a personable service. Please ask a member of our sales team for further details.

### Bernards Mortgage & Protection

We have a team of advisors covering all our offices, offering a comprehensive range of mortgages from across the market and various protection products from a panel of lending insurers. Our fee is competitively priced, and we can help advise and arrange mortgages and protection for anyone, regardless of who they are buying and selling through.

If you're looking for advice on borrowing power, what interest rates you are eligible for, submitting an agreement in principle, placing the full mortgage application, and ways to protect your health, home, and income, look no further!

### Property Tenure

Leasehold



Energy Efficiency Rating		Current	Potential
Very energy efficient - lower running costs			
(92 plus)	A		
(81-91)	B		
(69-80)	C		75
(55-68)	D	58	
(39-54)	E		
(21-38)	F		
(1-20)	G		
Not energy efficient - higher running costs			
England & Wales		EU Directive 2002/91/EC	



LOWER FLOOR  
232 sq.ft. (21.5 sq.m.) approx.

UPPER FLOOR  
698 sq.ft. (64.9 sq.m.) approx.

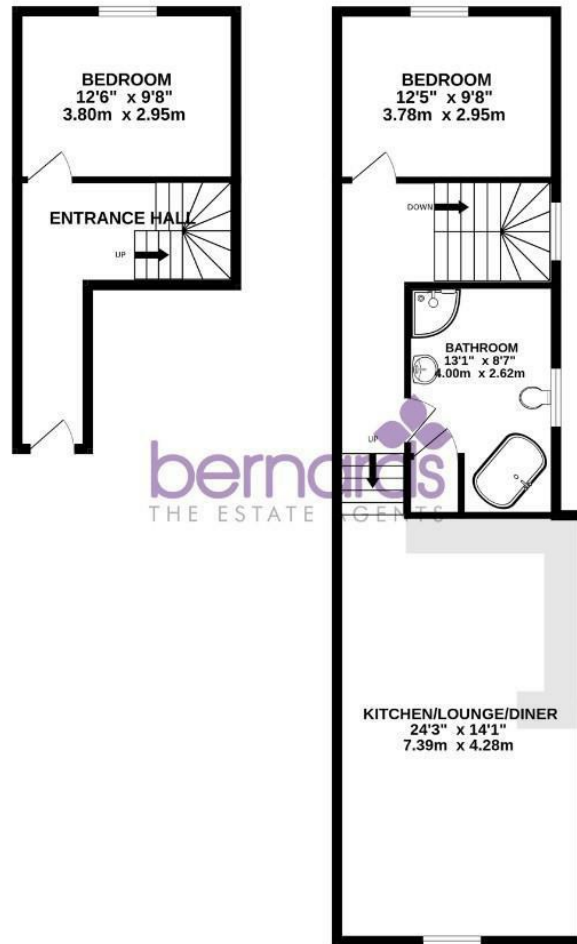

TOTAL FLOOR AREA : 930 sq.ft. (86.4 sq.m.) approx.

Whilst every attempt has been made to ensure the accuracy of the floorplan contained here, measurements of doors, windows, rooms and any other items are approximate and no responsibility is taken for any error, omission or mis-statement. This plan is for illustrative purposes only and should be used as such by any prospective purchaser. The services, systems and appliances shown have not been tested and no guarantee as to their operability or efficiency can be given.  
Made with Metroptik ©2023

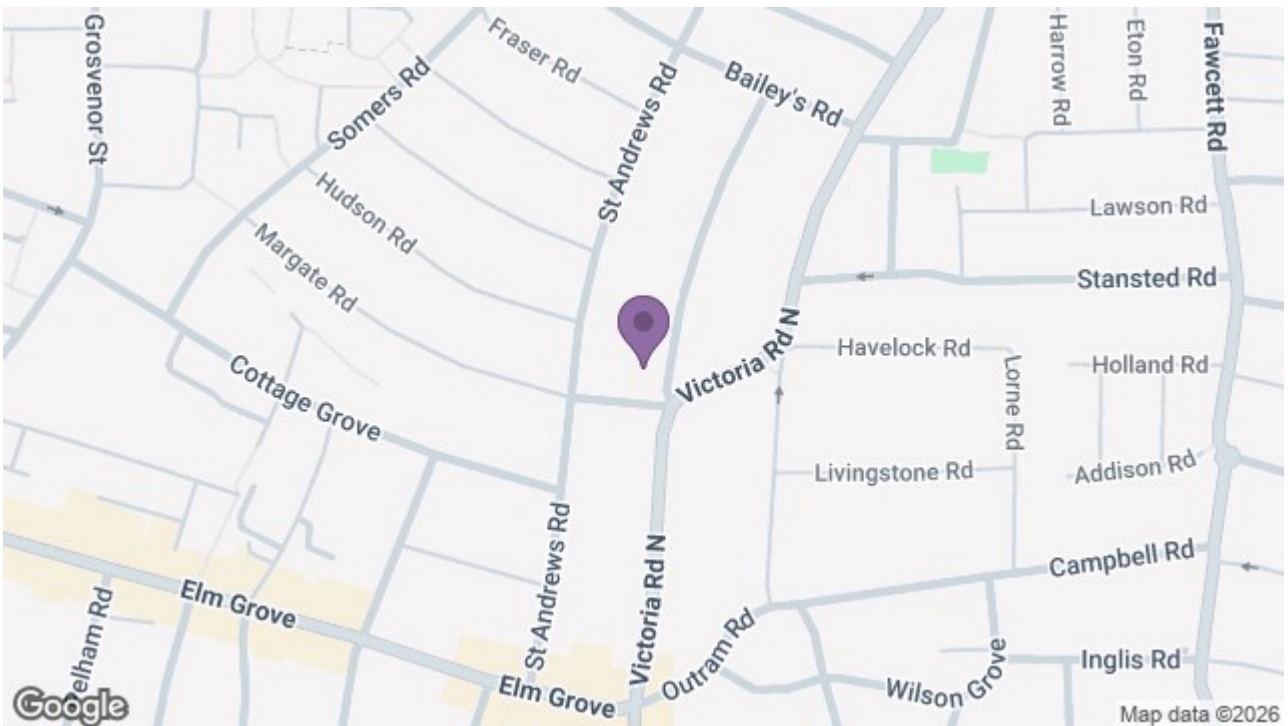

8 Clarendon Road, Southsea, Hampshire, PO5 2EE

t: 02392 864 974

